

RUGER® MAX-9®

PM1154

MANUAL SAFETY MODEL PISTOL SLIDE REPLACEMENT AND OPTIC INSTALLATION INSTRUCTIONS

**This Slide Kit Is Intended for Use With the
RUGER® MAX-9® Manual Safety Model Pistol ONLY!**

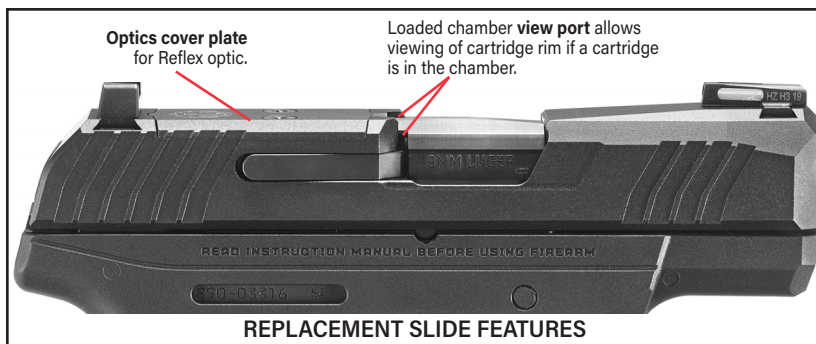

NEVER RELY ON YOUR MEMORY OR ANY LOADED CHAMBER INDICATOR OR VIEW PORT TO KNOW IF A FIREARM IS LOADED. ALWAYS VISUALLY CHECK THE CHAMBER BY RETRACTING THE SLIDE AND EXAMINING THE CHAMBER TO BE SURE WHETHER IT IS EMPTY OR LOADED.

REFLEX SIGHT MOUNTING

This **RUGER® MAX-9®** pistol slide has been machined to allow the direct mounting of micro red dot (reflex) sighting systems. Suitable optics include those of a J-Point-type mounting pattern utilizing M4 x 0.7mm threaded screws of the proper length. Please refer to the **RUGER® MAX-9®** pistol manual for additional information and important warnings.

Remove Slide From Frame:

1. **Keep the pistol pointed in a safe direction!** Press the magazine latch and remove the magazine (see Figure 1).



2. With the safety in the "fire" position, pull the slide to the rear and lock the slide in the open position by pushing upward on the slide stop (see Figure 2).



3. Inspect the chamber and verify that it is empty (see Figure 3).

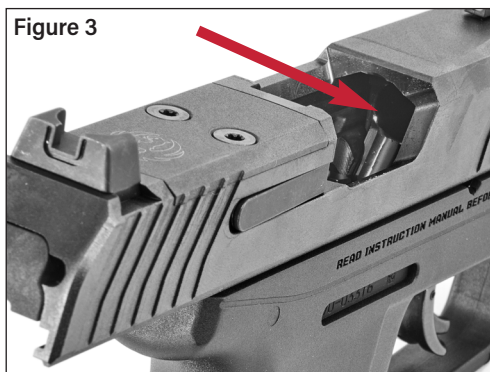

4. Retract the slide slightly and release it (see Figure 4). This will disengage the slide stop and allow the slide to move fully forward.

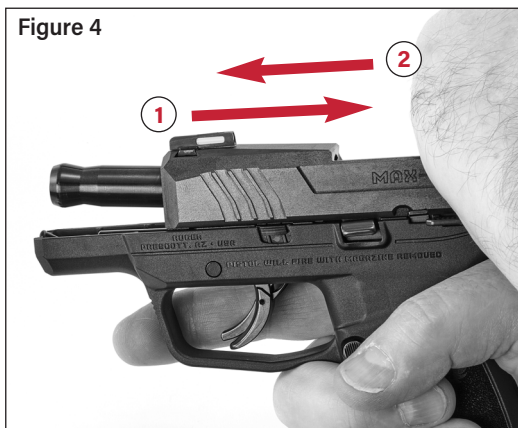

5. Be sure the pistol is pointed in a safe direction. Pull the trigger to release tension on the striker (see Figure 5).



Figure 5

6. Using a finger or a "soft" tool, push the takedown plate fully down to expose the takedown pin (see Figure 6).



Figure 6

7. The slide must be pulled rearwards approximately 1/8" and held before you can insert a small punch or paper clip into the slot on the right side of the frame (see Figure 7a) to push the takedown pin out the left side of the pistol (see Figure 7b).



Figure 7a



Figure 7b

8. Move the slide assembly forward and separate it from the grip frame (see Figure 8). **NOTE:** If the slide assembly will not move forward, you likely cocked the striker while manipulating the slide. In that case, repeat step 5 above and remove the slide assembly.



Remove Optics Cover Plate:

1. Using an IP10 (Torx Plus®) or a T10 (Torx®) wrench (provided), remove the two screws retaining the optics cover plate (see Figure 9). Be sure to keep the screws and the optics cover plate for future re-installation.

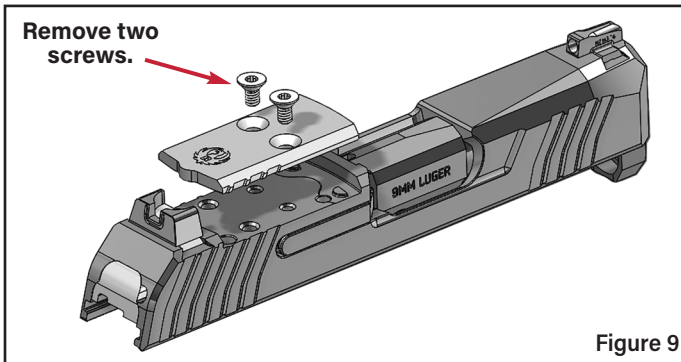

2. Skip this step if mounting the Holosun HS407K or HS507K micro red dot sight. For all others: Locate the envelope containing two small metal dowel pins and, using tweezers or needle-nose pliers, install the two dowel pins into the rearmost holes in the slide, as shown in Figure 10. The pins will be a slip fit in the holes and will drop freely into the holes when lined up properly. In the event you want to remove your optics reflex sight, the pins can remain in their locating holes and the optics cover plate can then be reinstalled using the supplied cover screws.

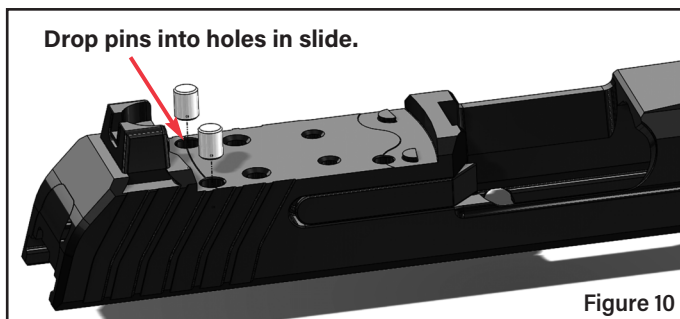

3. Test fit the optic in the milled area on the pistol slide. Make sure the optic is resting flat on the slide and positioned over the two studs and two dowel pins (if required).
4. Attach the optic using two M4 x 0.7mm thread pitch screws provided by the optic manufacturer. Be careful to check whether the two screws bottom out before the optic is tight. In the event this happens, remove the two screws and grind or file a small amount off the bottom of each screw. Reinstall the screws and repeat as necessary. Tighten the screws according to the manufacturer's specifications. **CAUTION: Over-tightening may cause damage!** Instead, a very small amount of non-permanent thread locking compound (typically blue) may be applied to the screw threads before assembly to ensure stability.

Maintenance: Check screw tightness on a regular basis and re-tighten to the optic manufacturer's specifications as necessary. If an optical sight is not mounted on the slide, reinstall the optics cover plate using the IP10 (Torx Plus) or a T10 (Torx) wrench (provided) and tighten the original screws to 26 in/lbs.

Reinstall Slide:

1. Be certain the chamber and magazine are empty and there is no magazine inserted in the frame.
2. Reinstall the slide onto the frame (see Figure 11) and place the slide in its "closed" position, as if the pistol were fully assembled.

NOTE: The slide should never be installed on the frame without first installing the barrel and guide rod assembly into the slide.

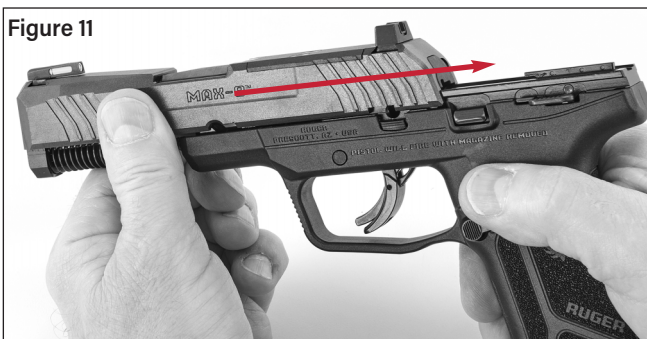

3. Make sure that the takedown plate is pressed fully downward (see Figure 6, p. 3). Pull the slide slightly rearward to allow the pin to clear the slide, about 1/8 inch. Insert the takedown pin into the frame insert (see Figure 12) making sure that it is flush with the frame insert. Move the takedown plate upward until it snaps into place. **NOTE:** The slide should not be fully racked (operated) without the takedown pin securely installed.

