

RUGER® PC CARBINE™

MAGPUL ACCESSORY KIT INSTALLATION INSTRUCTIONS

NOTE: For customers installing the Magpul PC Backpacker Stock. This kit removes the modular handguard mount and replaces it with the standard takedown block in order to mount the Magpul forend.

TOOLS REQUIRED:

- T10 x 80 Torx Bit
- 5/32" Allen Wrench
- 1/8" Allen Wrench
- 9/64" Allen Wrench

Rifle Must Be Completely Unloaded Prior to Disassembly

CAUTION: Be sure to wear shooting glasses as some parts are under spring pressure.

REMOVE BARREL/HANDGUARD ASSEMBLY:

1. With the rifle pointing in a safe direction, remove the magazine, lock the bolt back (see Figure 1) and visually make certain there is not a cartridge in the chamber.

2. To remove the barrel/handguard assembly, with the bolt still in the locked back position, push the locking lever forward to unlock the barrel/handguard assembly. While holding the locking lever forward, rotate the barrel/handguard assembly counterclockwise and pull the barrel/handguard assembly out of the receiver. (See Figure 2.)



Figure 1

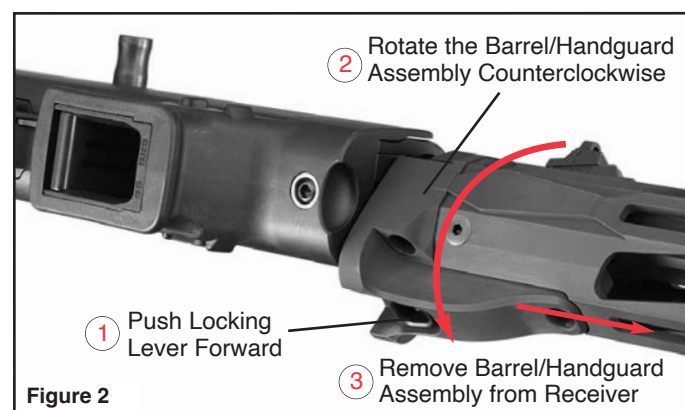

Figure 2

3. For PC Carbiners with a front sight: Using a T10 x 80 Torx bit, remove the two front sight screws by turning them counterclockwise and slide the front sight off the barrel. (See Figures 3a & 3b.)

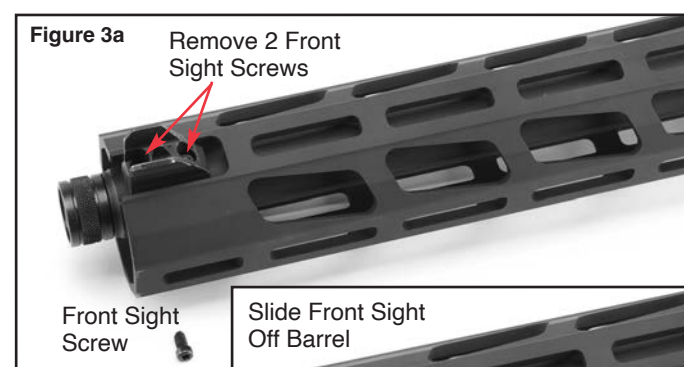

Figure 3a



Figure 3b

4. Using a 1/8" hex wrench, loosen and remove the four handguard screws by turning them counterclockwise. (See Figure 4.)

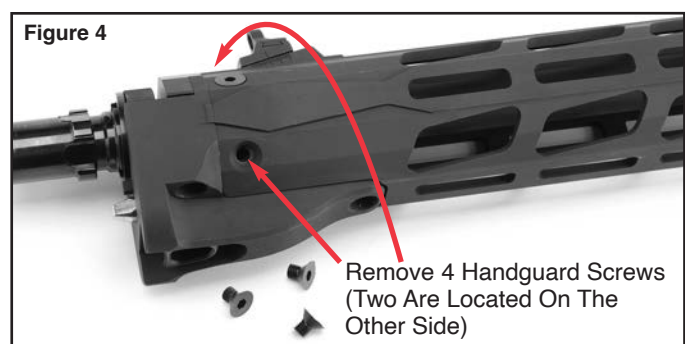

Figure 4

5. Carefully slide the handguard off the barrel. Be careful not to allow the handguard to contact the barrel as this could scratch the barrel. (See Figure 5.)

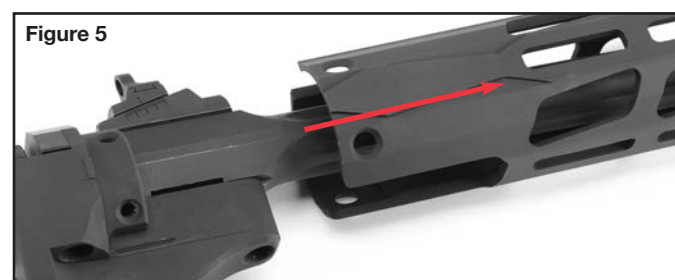

Figure 5

MODULAR HANDGUARD MOUNT DISASSEMBLY:

1. Using a 5/32" allen wrench, remove the two barrel clamp screws from the bottom of the handguard mount. (See Figure 6.)
2. Using a 9/64" allen wrench, remove the front socket head screw from the bottom of the handguard mount. (See Figure 6.)

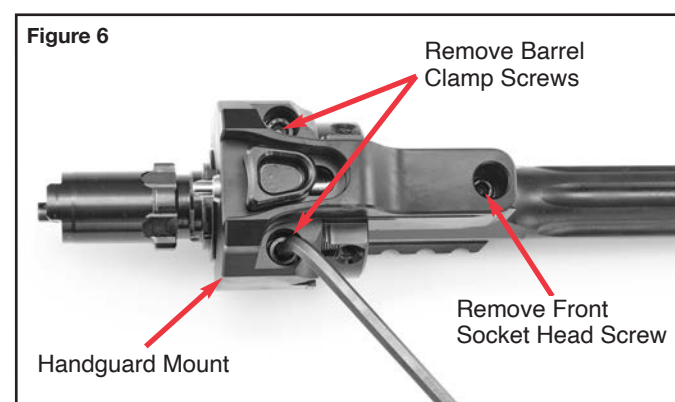

Figure 6

3. With the screws removed, lift off the modular handguard mount. (See Figures 7a & 7b.)
4. Next, remove the handguard clamp. (See Figure 8.)

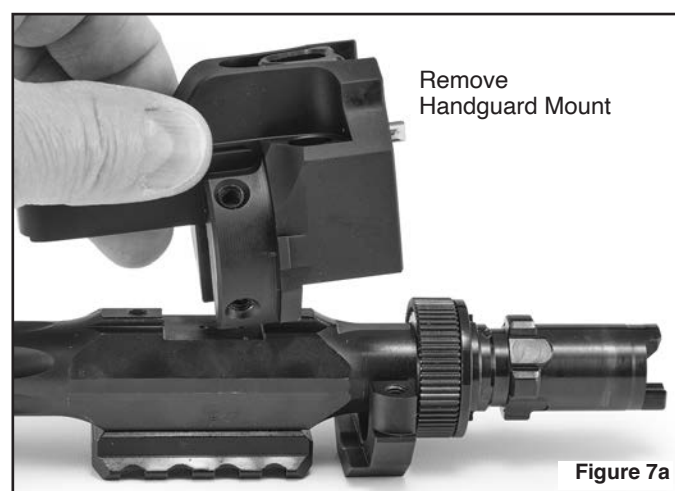

Figure 7a

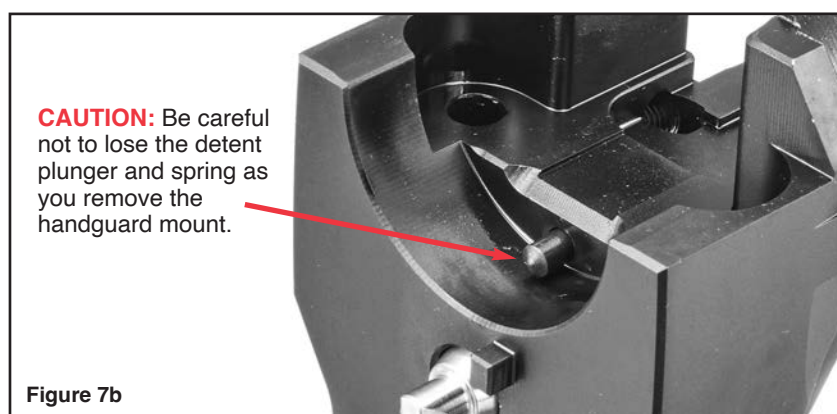

Figure 7b



Figure 8

STANDARD TAKEDOWN BLOCK INSTALLATION:

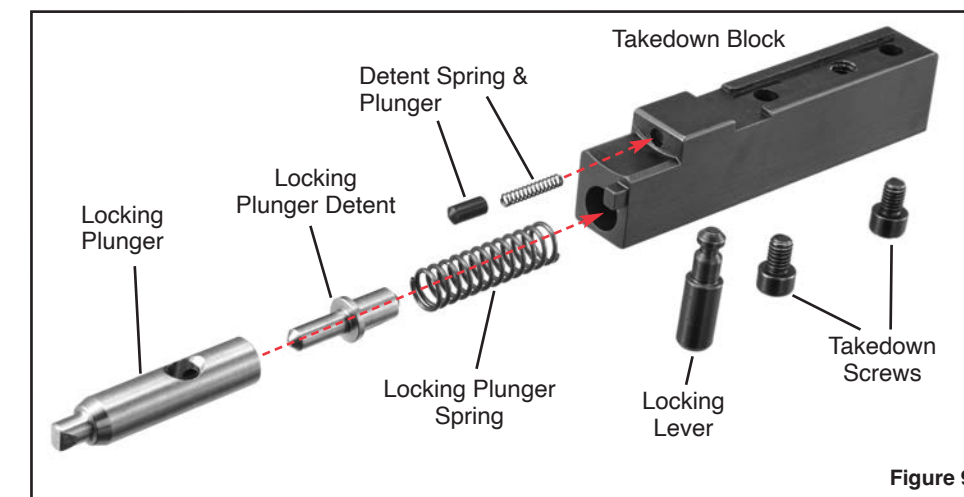

Figure 9

1. Insert the detent spring and plunger into the takedown block, spring first. (See Figures 10a & 10b.)

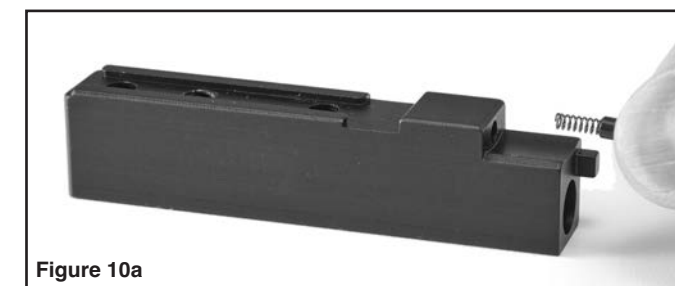

Figure 10a

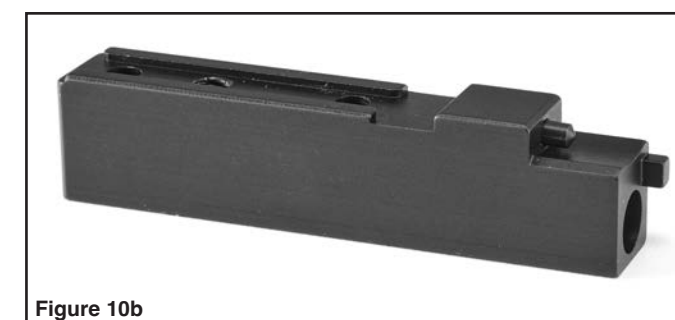

Figure 10b

2. Position the takedown block assembly on the barrel assembly so that the detent plunger makes contact with the adjustment ring. (See Figure 11.)

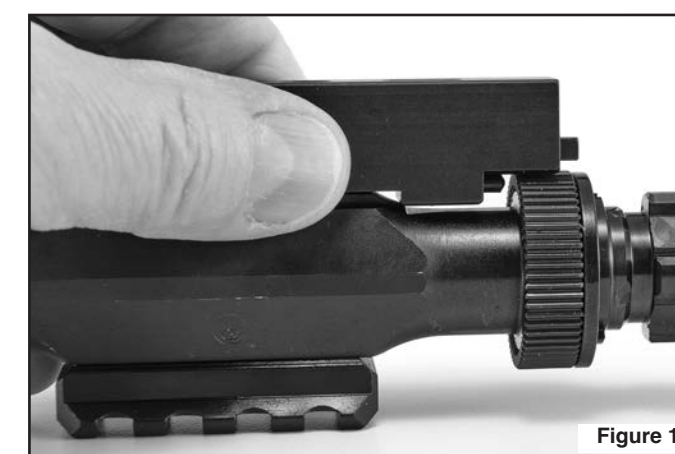

Figure 11

3. Position the takedown block assembly on the barrel assembly so that the detent plunger makes contact with the adjustment ring. (See Figure 12.)



Figure 12

– Please See Reverse Side For Additional Instructions –

4. With a 9/64" hex wrench, install the rear mounting screw and tighten the screw to 40-45 in-lbs of torque. (See Figures 13a & 13b.)

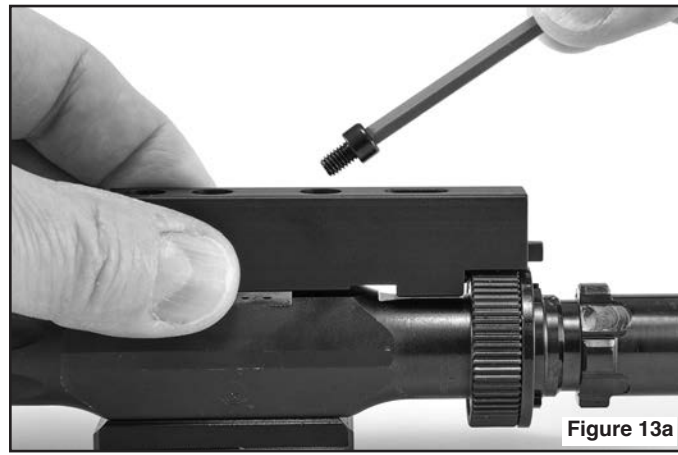

4. With a 9/64" hex wrench, install the front mounting screw and tighten to 40-45 in-lbs of torque. (See Figure 14.)

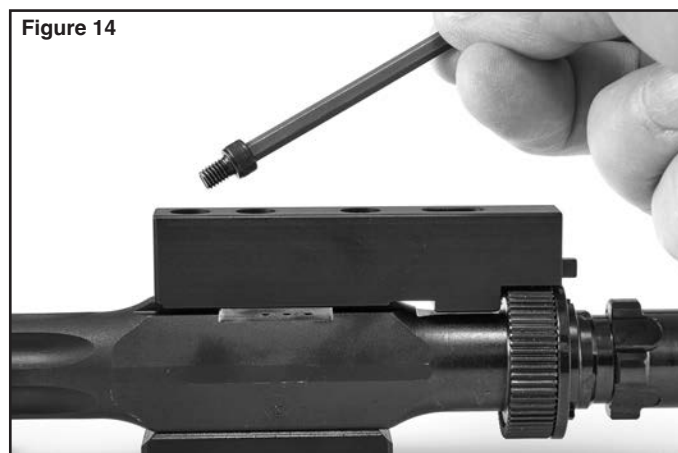

5. Insert the non-directional locking plunger spring into the takedown block. (See Figure 15.) Refer to Figure 9 page 3, for correct part names and order of parts installation.

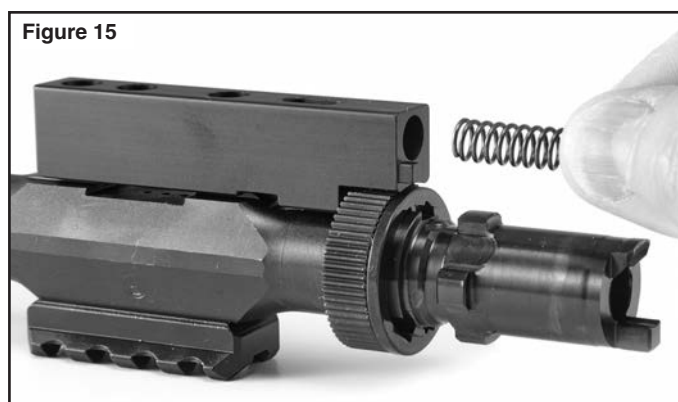

6. Insert the locking plunger detent into the locking plunger. (See Figure 16.)

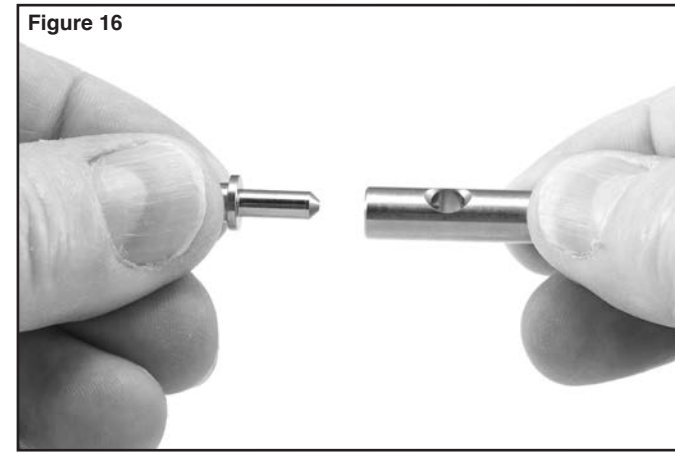

7. Insert the locking plunger assembly into the locking plunger spring in the takedown block, keeping the locking lever hole upward. (See Figure 17.)

WARNING: The locking plunger assembly will be under heavy spring tension.

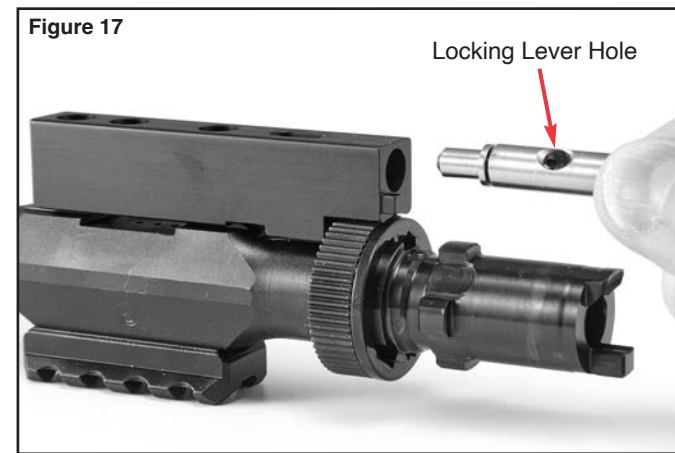

8. Using the back of a punch, compress the locking plunger and insert a small screwdriver into the gap between the locking plunger and locking plunger detent. (See Figure 18.)

WARNING: The locking plunger assembly will be under heavy spring tension.

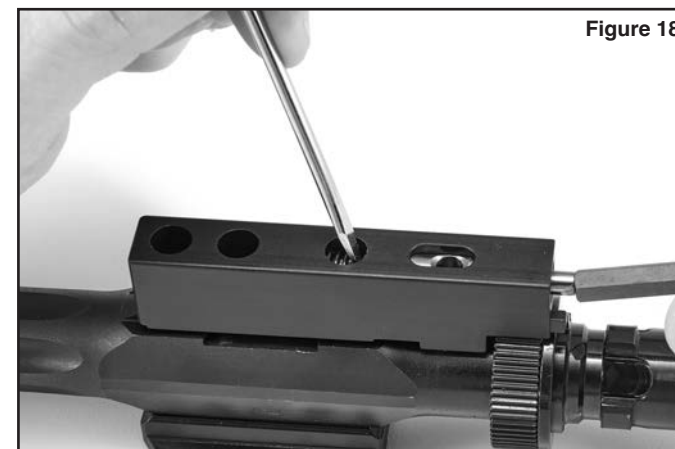

9. Keep downward pressure on the screwdriver to hold the tension of the locking plunger spring. (See Figure 19.)



10. Insert the locking lever into the locking plunger. (See Figure 20.)

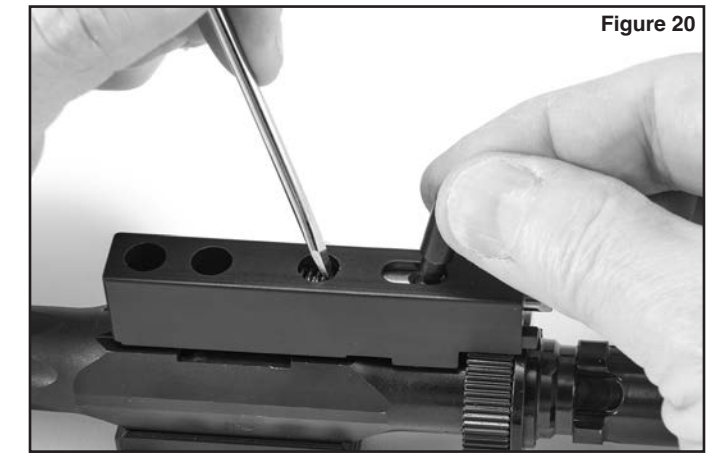

11. Hold down the locking lever and remove the screwdriver. (See Figure 21.)

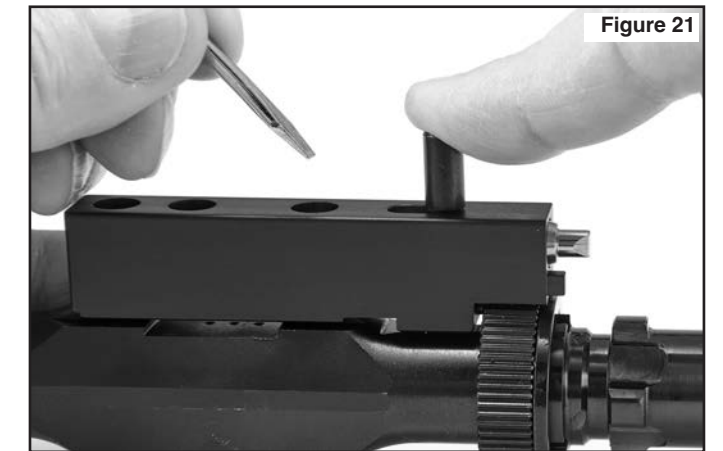

12. For PC Carbines with a front sight: Reinstall the front sight.

NOTES